



Meeting room solutions

Technology to support hybrid meetings

The pandemic effect on meetings

At the start of the Coronavirus pandemic in early 2020, we all shifted to home working and many of us spent much of that year in a series of Teams, webinars and online conference calls.

Meetings where the participants were all dialling in individually from home worked well. But as offices reopen and organisations embrace a hybrid way of working, we are now faced with a whole new set of challenges.

- Increasingly meetings are going to be made up of a mix of 'in room' participants, and remote participants
- Meeting room tech has not kept up with the new demands – cameras don't pick up all the people around the table, remote participants get a second class experience and collaborating on whiteboards and flip charts becomes increasingly difficult.
- Open plan offices make it hard to take Teams calls and users are left scrabbling for a quiet space away from colleagues
- Customers are no longer visiting your office in person, their first impression of you is what they see when they connect to your conference room
- Staff are unsure how to best connect when they enter your meeting room – wasting the first 10 minutes of every meeting as people struggle to get complicated tech working
- A recent survey shows less than 5% of organisations have adequate video conferencing solutions in their meeting rooms.

To address these challenges we have created some meeting room solutions to support hybrid meetings with a mix of 'in room' attendees and remote attendees.

Microsoft Teams room solutions



Technology for collaboration

Microsoft Teams Rooms transforms any space to a Teams meeting place with one-touch join, easy content sharing, and centre of room control for Microsoft Teams and Skype for Business meetings.

We have worked with the leading UK IT distributor to create technology bundles to suit organisations of different sizes. Using Logitech Room Solutions for Microsoft Teams the solutions include everything you need to build out conference rooms with one or two displays.

Available for small, medium, and large meeting rooms the solutions all include the Logitech Tap Room Solution which allows you to join and manage meetings without your laptop. Using the solution you can easily add participants to the meeting (including dialling phone numbers) you can manage the lobby, mute participants, highlight a participants video, adjust the layout on the main display to show just shared content, or participants videos, you can share content either via your laptop or phone and you can display a whiteboard using Microsoft Whiteboard in Teams.



Small room bundle

The small room bundle is suitable for meetings up to 6 people, it is designed for focus rooms and smaller conference rooms.

The small configuration minimizes cabling and saves space with Logitech MeetUp, a marvel of miniaturisation that mounts neatly above or below a display. Place Logitech Tap on the table, or add a wall mount to save even more space.

The small room bundle includes

- Logitech Tap Room Solution for Microsoft Teams (includes Tap controller and Logitech MeetUp)
- Sony BRAVIA 55" 4k TV Screen
- Vision Heavy Duty Tilting Flat-Panel Wall Mount for Display
- Onsite installation of Logitech Room Solution with display



The small room solution is designed so that the camera will capture the faces of participants located within 1-3 metres, the directional microphone and speakers have a range of 3.5 metres to pick up the voices of all the participants and project the audio effectively in a small meeting room space.

Medium room bundle

The medium room bundle is suitable for medium sized meeting rooms up to 11 people

As rooms get bigger, tables grow longer and people sit farther from the camera. That's why the medium configuration features Logitech Rally, a premium conference camera that pairs an advanced ultra-HD camera with modular audio that scales to support a wide range of room sizes and layouts.

The medium room bundle includes

- Logitech Tap Room Solution for Microsoft Teams Medium (includes Tap controller, Logitech Rally system with Rally Mic Pod, Speaker, Display hub, table hub and Logitech Camera)
- Sony BRAVIA 65" 4k TV Screen
- Vision Heavy Duty Tilting Flat-Panel Wall Mount for Display
- Onsite installation of Logitech Room Solution with display



The medium room solution is designed so that the camera will capture the faces of participants located within 1- 5 metres, a microphone pod can sit in the middle of the table to capture all the participants voices and the speaker has a range of 4.5 metres to project the audio effectively in a medium meeting room space.

Large room bundle

The large room bundle is suitable for large sized meeting rooms for up to 16 people.

The large configuration upgrades to Rally Plus with two speakers for clear audio throughout the room. Dual mic pods expand coverage for up to 16 people, and the system supports up to 7 mic pods for rooms with up to 46 seats

The large room bundle includes

- Logitech Tap Room Solution for Microsoft Teams Large (includes Tap controller, Logitech Rally system with 2x Rally Mic Pod, 2x Speaker, Rally mix Pod Hub, Display hub, table hub and Logitech Camera)
- Sony BRAVIA 75" 4k TV Screen
- Optional 2nd screen
- Vision Heavy Duty Tilting Flat-Panel Wall Mount for Display
- Onsite installation of Logitech Room Solution with display



The large room solution has the capacity for two displays, one can display participants video and one for sharing screens and presentations, the Tap room solution can be used to change what's on each display, the camera will capture the faces of participants located within 1-7.4 metres, two microphone pods can sit on the table to capture all the participants voices and the speaker has a range of 7.5 metres to project the audio effectively in a large meeting room space.

Optional extras and accessories

ramsac
the secure choice

Logitech Swytch

Logitech Swytch allows you to connect a laptop to a room system's AV equipment for use with any meeting. Using DisplayLink Plug-and-Display technology to allow screen streaming via the same USB cable all you need to do is plug the Swytch Connector into a laptop with a USB port. No dongles, no splitters, no HDMI required.

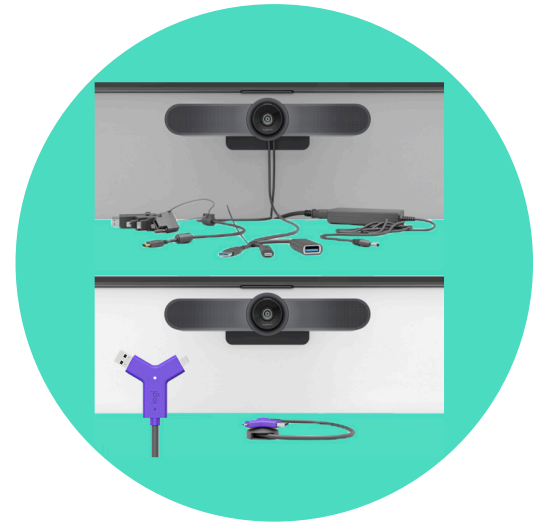

Content Camera

Content Camera is a second camera connected to a Microsoft Teams Room PC and is used with an "analogue" whiteboard or flip chart. Special image processing software and a whiteboard allow a presenter to draw and share the content with remote participants.



Interactive Flat Panels

Why not upgrade the room to support Microsoft Whiteboard. Microsoft Whiteboard is the freeform infinite digital canvas and allows you to transform your work into professional looking charts and shapes with an interface designed for pen and touch. You can bring your team together on the same virtual canvas, around the world and across devices. The whiteboards stay safe in the cloud until you're ready to return to them, from the same or another device.

Other vendors and options

Other vendors are available within the Microsoft Teams Rooms space including HP and Lenovo. As well as this there are a large number of video conferencing devices available that are certified for Microsoft Teams Rooms including vendors like Bose, Huddly and Lenovo.

Find out more

For more information on meeting room technology please get in touch:

Call: **01483 412 040**

Email: **info@ramsac.com**

Visit: **www.ramsac.com**

ramzac Limited

www.ramsac.com

01483 412 040

The logo consists of a teal circle followed by the word "ramzac" in a bold, white, sans-serif font. Below "ramzac" is the tagline "the secure choice" in a smaller, white, sans-serif font.
ramzac
the secure choice